

RANGE 2 & 3

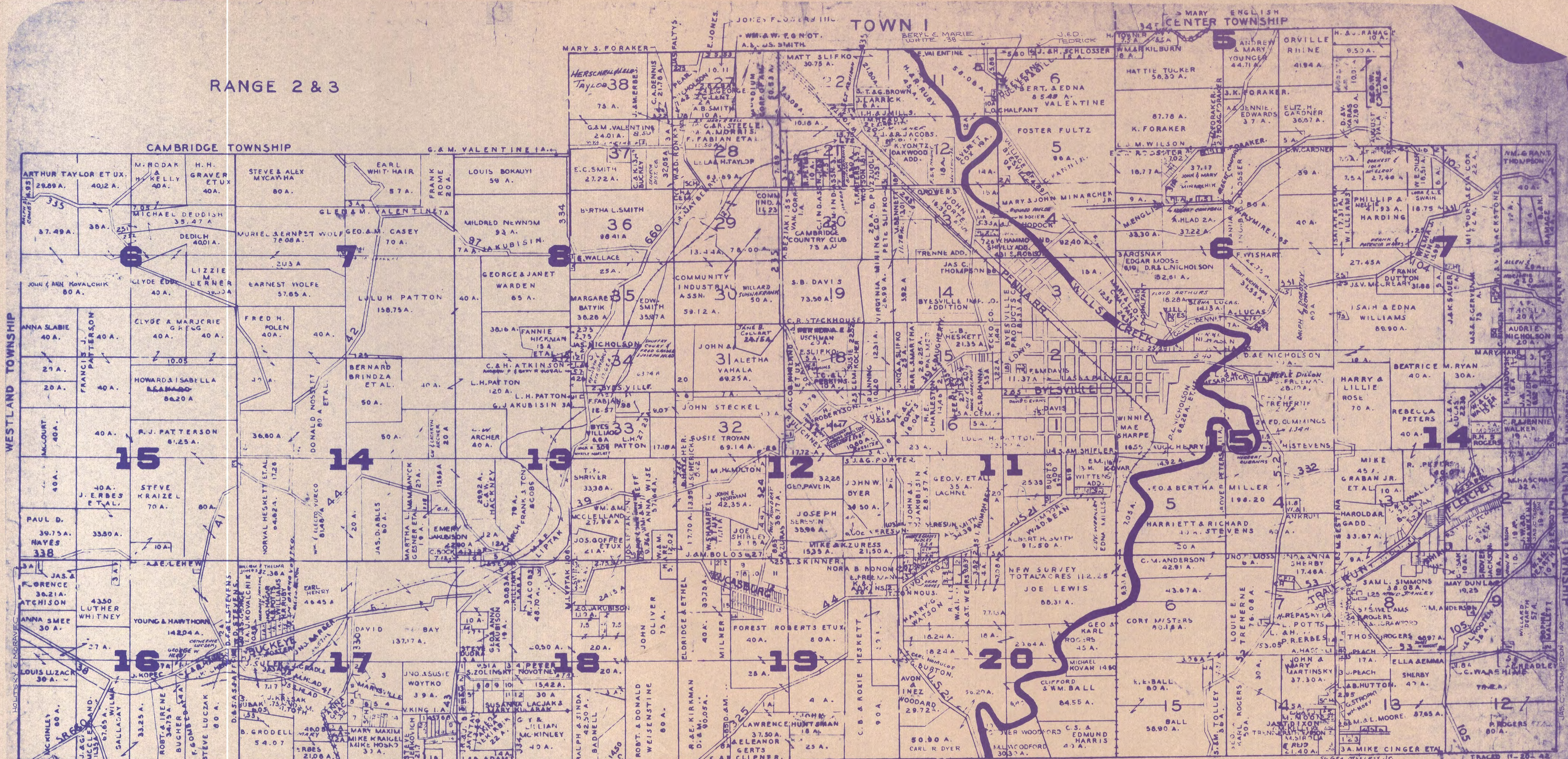

THOS. AMARY SLIFKO SECTION 8 L.77

MARY ENGLISH	3.0
D.R. ENGLISH	1.30
EDWARD MODSE	1.02

SECTION 11

RALPH REIS	3.7
------------	-----

SECTION 12

MICHAEL P. GEEK JR.	1.0
---------------------	-----

SECTION 13

WASHINGTON B. SISE	1.25
M.A. S. SLIFKO	1.00
FRANCIS Y. JM	1.00
M.A.M. LIPTOK	1.00
T.J. JACOBS	3.47
ANNA SLIFKO	1.00
WM. CHARLTON	3.9
ANNIE GORFE	5.00
J.P. KATER	0.61

SECTION 14

J.P. KATER	0.61
ANNIE GORFE	5.00
ROSS VIN. SNT	1.22

SECTION 15

E.R.D. CUMMINGS	2.34
WOS. WATLINSK	1.13

SECTION 17

JNO. BARBER	1.50
V.L.T. THOMPSON	1.93

SECTION 18

FREDMAN GREEN	1.5
---------------	-----

LOT 16

Geo. M. Hlad	1.00
--------------	------

SEC. 13

J.A.P. JAKUBISIN	7.2
------------------	-----

LOT 17

JAS. & RUBY REDES	4.21
YONE	5.0

SECTION 17

MARY ENGLISH	1.00
D.R. ENGLISH	1.30
EDWARD MODSE	1.02
RALPH REIS	3.7
MICHAEL P. GEEK JR.	1.0
WASHINGTON B. SISE	1.25
M.A. S. SLIFKO	1.00
FRANCIS Y. JM	1.00
M.A.M. LIPTOK	1.00
T.J. JACOBS	3.47
ANNA SLIFKO	1.00
WM. CHARLTON	3.9
ANNIE GORFE	5.00
J.P. KATER	0.61

SECTION 17

ADOL. DEVOLLE	3.0
FRED BRIMLEY	1.74
THOS. ARITA YONO	15.05
W.A. KACHILA	4.09
R.A.M. THOMPSON	7.7
J.M. FALKASKY	1.17
ANNA GRAC	2.00
JNO. WALKER	2.11
JNO. BARBER	1.93
V.L.T. THOMPSON	1.93
FREDMAN GREEN	1.5

SECTION 17

JOHN & MANDY EBBES	0.40
Willard of Mary ABRAHAM	3.18

LOT 11

R. CURTIS BROWN ETAL	.98
----------------------	-----

VALLEY TOWNSHIP

LOT 21

MATT ASUSTE SLIFKO 2.87A.

JACKSON

SECTION 18

MILDRED V. KING	.41
S.Z. TOLEBISKY	1.10
J.H. HARTLEY	1.00
MIKE KRUPAR	1.00
GEORJAKUBISON	1.00
J. KOVAL ETUX.	0.59
STEVE J. PETRASKO	1.33
P. PETRASKO	2.5
GABRIEL MCKINLEY	2.5
ANDY & ANNA YAKUBIK	1.00
STEVE MOTIL	1.00
ANDY KATTA	.94
MIKE KRUPAR	.94
MARY HILGARY	.94
LOLA JAKUBISON	.94
BOW. HOFFMANN	.25
JNO. SHERBY	.03
GEORJAKUBISON	3.20
MCKINLEY YAKUBIK & JNO.	1.00
JNO. KASER	1.00
ANDY ASUSTE SLIFKO	.97
STEVE & C. MOTTID	1.80
J.A.J. HUFF	2.80

SECTION 19

WM. & M. SHAMPEL	1.30
PAUL & MARY VOYTKO	1.25
W.E. ZURESS	3.13
JNO. SHERBY	3.95
THOS. DZURIK	5.55
ROBERTA SHAMPEL	1.00
GEOR. GRABON	1.00
STEVE CARNEY	1.00
GEOR. GRABON	2.00
MIKE YASENSKY	3.00
WUOSS	4.00
C.E. L.F. & C. CO.	7.83
CAROLINE KUBON	3.90
JOS. & MARY BOLOS	11.25
WILLIAM L. SILLS	1.12

LOT 3

JACK A. TOUVILLE 4.00

VILLAGE BYESVILLE 4.43

LOT 2

FRANK FLEISCHER	5.0
VARY GOZUR	2.5
HURON	2.5
320. SULLIN	2.5
MIKE HASCHAK	2.5
A. UNRN	2.5
ANDY HASCHAK	2.5

LOT 3

J.S.E. KOSUTH	2.5
C.E. SULLIN	5.36
BEULAH WILLIAMS	1.11

LOT 7

PAUL V. PALLATI 1.9

LOT 1

E. & MARG. MILLER	1.25
WILLIAM S. HENDERLEY	3.33
NICK M. SUTELNIK	1.00
THOS. & GOLDIE ROGERS	1.00

LOT 13

E. SHERBY	5.0
JAS. AT. DIXON	5.0
E. SHERBY	3.0
E. SHERBY	3.0
JOSEPHINE SHERBY	3.0

LOT 14

CHAS. BARTHOLOW

LOT 15

A.F. SIGMAN	2.3
173 V. HANNAN	2.2
MARIE & STEVE SHIELER	2.2
WILL BANK SAMBO	1.0
WILLIAM L. SILLS	.90

LOT 16

VILLAGE BYESVILLE 3.37

LOT 17

VILLAGE BYESVILLE 2.3

LOT 17 & 18

J.H. HARTLEY 3.7

LOT 27

R.A. KAPLAN 3.42

LOT 18

E. & A. GEORGE 21.00

LOT 34

FRED GRACE 1.57

LOT 5

STEVE & MARY H.K.D. 4.40

LOT 15

MARY ROMANE 3.90

E. MC DANIEL 1.26

LOT 27

E. DILLMORE 1.33

2.00

LOT 15

S. HEGEDUS .09

MAURICE ROGERS .69

LOT 7

G. EDW. HUFFMAN 1.95

PAUL STILLICHS 1.00

LOT 6

ROBERT A. GADD .25A

SAM'L. SIMMONS .01

LOT 8

LOT 15

HOMER & CHARLESTON 1.00

HOMER & CHARLESTON 1.09

SECTION 11

JOHN & ANNA PAVLICK .58A

LOT 14

HELEN RUDD .75A

LOT 15

WM. & FLORENCE PARKS 2.00A.

W.B. & E. HOOTS 2.39

JERRY & G. PALMER 0.25F

LOT 13

EDGILE & ANTI KORTE .37A

LOT 8

DAIRY of LORAIN SIMMONS 3.00A.

LOT 33

FRANK FABIAN 1.43A.

SEC. 20

ROSA & MONA SCHLOSSER 2.00A.

SEC. 14

GLOVIS & JENNIE WALKER 3.00A.